











Impact accessories 1/4" Akcesoria udarowe 1/4"		62	Impact accessories 3/4" Akcesoria udarowe 3/4"		65
Impact universal joints Przeguby kuliste udarowe.....		62	Impact extension bars Przedłużki udarowe.....		65
Impact accessories 3/8" Akcesoria udarowe 3/8"		62	Impact adapters Redukcje udarowe.....		65
Impact universal joints Przeguby kuliste udarowe.....		62	Impact universal joints Przeguby kuliste udarowe.....		65
Impact sockets 1/2" Klucze nasadowe udarowe 1/2"		62-63	Impact sockets 1" Udarowe klucze nasadowe 1"		66
Impact sockets & sets Klucze nasadowe udarowe i zestawy, krótkie.....		62	Impact sockets Klucze nasadowe udarowe, krótkie.....		66
Deep impact sockets & sets Klucze nasadowe udarowe i zestawy, długie.....		63	Deep impact sockets Klucze nasadowe udarowe, długie.....		66
Impact accessories 1/2" Akcesoria udarowe 1/2"		63-64	Impact accessories 1" Akcesoria udarowe 1"		66
Impact extension bars Przedłużki udarowe.....		63	Impact extension bars with adapter Przedłużki udarowe z redukcją.....		66
Impact adapters Redukcje udarowe.....		63	Impact universal joints Przeguby kuliste udarowe.....		66
Impact universal joints Przeguby kuliste udarowe.....		64	Impact accessories sets Zestawy akcesoriów udarowych		66-67
Impact sockets 3/4" Udarowe klucze nasadowe 3/4"		64-65	Impact sockets for front hub nuts Nasadki udarowe do piast		67
Impact sockets & sets Klucze nasadowe udarowe i zestawy, krótkie.....		64	Impact bit sets & accessories Zestawy bitów udarowych i akcesoria		67-69
Deep impact sockets & sets Klucze nasadowe udarowe i zestawy, długie.....		64			

EN Impact universal joint  
 PL Przegub kulisty udarowy  
 DE Kraft-Kugelgelenk  
 RU Ударный шаровой шарнир  
 CZ Kulový rázový kloub  
 HU Csuklós csatlakozó gépi  
 RO Articulație universală de impact  
 FR Joint universel à impact  
 IT Giunto universale a impatto  
 ES Junta de impacto universal  
 CN 重型气动方向接头

**1/4"**  
6.3mm **CrMo**  
SCM440 **FOR IMPACT TOOLS DO NARZĘDZI UDAROWYCH**



EN Impact universal joint  
 PL Przegub kulisty udarowy  
 DE Kraft-Kugelgelenk  
 RU Ударный шаровой шарнир  
 CZ Kulový rázový kloub  
 HU Csuklós csatlakozó gépi  
 RO Articulație universală de impact  
 FR Joint universel à impact  
 IT Giunto universale a impatto  
 ES Junta de impacto universal  
 CN 重型气动方向接头

**3/8"**  
9.5mm **CrMo**  
SCM440 **FOR IMPACT TOOLS DO NARZĘDZI UDAROWYCH**



YATO	Ø	D1 [mm]	D2 [mm]	L [mm]	PCS
YT-10630	1/4" (6.3 mm)	17	8.3	34.5	20/200

YATO	Ø	D1 [mm]	D2 [mm]	L [mm]	PCS
YT-10632	3/8" (9.5 mm)	24.6	12.8	48	20/100

EN Hexagonal impact socket  
 PL Nasadka udarowa sześciokątna  
 DE Kraftschrauber-Einsatz  
 RU Головка ударная 6-гранная  
 CZ Šestihranný nástavec  
 HU Gépi dugókulcs hatszög

RO Cheie tubulară hexagonală de impact  
 FR Douille à choc  
 IT Chiave a bussola esagonale per percussione  
 ES Boquilla de percusión  
 CN 风动套筒

**1/2"**  
12.7mm **CrMo**  
SCM440 **AS-DRIVE**



YATO	Ø A [mm]	D1 [mm]	D2 [mm]	L [mm]	PCS
YT-1000	10	17.5	25	39	60
YT-1001	11	18.5	25	39	60
YT-1002	12	20.0	25	39	60
YT-1003	13	21.0	25	39	60
YT-1004	14	22.5	25	39	60
YT-1005	15	23.5	30	39	40
YT-1006	16	24.0	30	39	40
YT-1007	17	26.0	30	39	40
YT-1008	18	27.5	30	39	40
YT-1009	19	28.0	30	39	40
YT-1010	20	30.0	30	39	40
YT-1011	21	30.0	30	39	40
YT-1012	22	32.0	30	39	30
YT-1013	23	32.0	30	39	30
YT-1014	24	34.0	30	43	30
YT-1015	25	35.0	30	43	30
YT-1016	26	38.0	30	43	24
YT-1017	27	38.0	30	43	24
YT-1018	28	40.0	30	48	24
YT-1019	29	41.0	30	48	22
YT-1020	30	42.0	30	48	24
YT-1022	32	44.0	30	48	20

EN Impact socket set  
 PL Zestaw nasadek udarowych  
 DE Kraftschrauber-Einsätze  
 RU Набор торцевых ударных головок  
 CZ Sada úderových nástrojných hlavic  
 HU Gépi dugókulcs készlet  
 RO Set chei tubulare pt. impact  
 FR Jeu de douilles à choc  
 IT Set di chiavi a bussola a percussione  
 ES Juego de vasos de impacto  
 CN 风动套筒组套

**10**  
PCS **1/2"**  
12.7mm **CrMo**  
SCM440 **AS-DRIVE**



YATO	Ø	PCS
YT-1025	1/2" (12.7 mm)	20

1/2" (12.7 mm): 10, 12, 13, 14, 15, 16, 17, 18, 19, 22 mm (L=39 mm)

EN Hexagonal deep impact socket  
PL Nasadka udarowa sześciokątna długa  
DE Kraftschrauber-Einsatz, lang  
RU Головка ударная 6-гранная глубокая  
CZ Sestihřanný hluboký nástavec  
HU Gépi dugókulcs hatszög hosszú

RO Cheie tubulară hexagonală de impact adâncă  
FR Douille profonde à choc  
IT Chiave a bussola esagonale per percussione  
ES Boquilla de percusión profunda  
CN 风动套筒

1/2" 12.7mm CrMo SCM440 AS-DRIVE

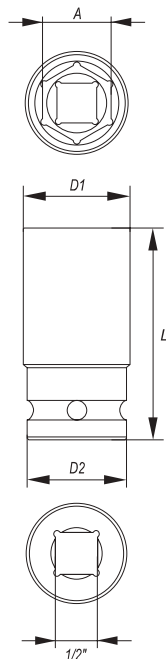

YATO	∅ A [mm]	D1 [mm]	D2 [mm]	L [mm]	PCS PCB	
YT-1030	10	17.5	24	78	30	120
YT-1031	11	18.5	24	78	30	120
YT-1032	12	20.0	24	78	30	120
YT-1033	13	21.0	24	78	30	120
YT-1034	14	22.0	24	78	30	120
YT-1035	15	23.7	24	78	30	120
YT-1036	16	24.0	24	78	30	120
YT-1037	17	26.0	26	78	25	100
YT-1038	18	28.0	28	78	24	96
YT-1039	19	28.0	28	78	24	96
YT-1040	20	30.0	30	78	20	80
YT-1041	21	30.0	30	78	20	80
YT-1042	22	32.0	30	78	18	72
YT-1043	23	32.0	30	78	15	60
YT-1044	24	34.0	30	78	15	60
YT-1045	25	35.0	30	78	15	60
YT-1046	26	38.0	30	78	12	48
YT-1047	27	38.0	30	78	12	48
YT-1048	28	40.0	30	78	12	48
YT-1049	29	41.0	30	78	10	40
YT-1050	30	42.0	30	78	10	40
YT-1052	32	44.0	30	78	10	40

EN Impact socket set  
PL Zestaw nasadek udarowych  
DE Kraftschrauber-Einsätze  
RU Набор торцевых ударных головок  
CZ Sada úderových nástřných hlavíc  
HU Gépi dugókulcs készlet  
RO Set chei tubulare pt. impact  
FR Jeu de douilles à choc  
IT Set di chiavi a bussola a percussione  
ES Juego de vasos de impacto  
CN 风动套筒组套



11 PCS 1/2" 12.7mm CrMo SCM440 AS-DRIVE

1/2" (12.7 mm): 10, 12, 13, 14, 15, 16, 17, 18, 19, 22, 24 mm (L=78 mm)

YATO	∅	
YT-1054	1/2" (12.7 mm)	10

EN Impact socket set  
PL Zestaw nasadek udarowych  
DE Kraftschrauber-Einsätze  
RU Набор торцевых ударных головок  
CZ Sada úderových nástřných hlavíc  
HU Gépi dugókulcs készlet  
RO Set chei tubulare pt. impact  
FR Jeu de douilles à choc  
IT Set di chiavi a bussola a percussione  
ES Juego de vasos de impacto  
CN 风动套筒组套



15 PCS 1/2" 12.7mm CrMo SCM440 AS-DRIVE

1/2" (12.7 mm): 10, 12, 13, 14, 15, 16, 17, 18, 19, 21, 22, 24, 27, 30, 32 mm (L=78 mm)

YATO	∅	
YT-1055	1/2" (12.7 mm)	4

EN Impact extension bar  
PL Przedłużka udarowa  
DE Verlängerung  
RU Удлинитель ударный  
CZ Prodlužovací příravek  
HU Toldalék  
RO Prelungitor  
FR Rallonge  
IT Prolunga per percussione  
ES Tubo de prolongación  
CN 风动接杆

1/2" 12.7mm CrMo SCM440

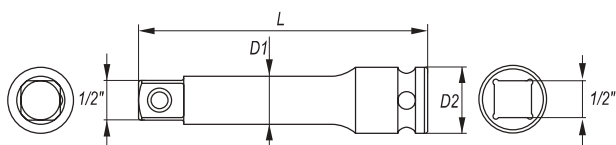

YATO	∅	D1 [mm]	D2 [mm]	L [mm]	PCS PCB	
YT-1060	1/2" (12.7 mm)	17.5	25	75	40	160
YT-1061	1/2" (12.7 mm)	18.5	25	125	28	112
YT-1062	1/2" (12.7 mm)	20.0	25	250	30	60

EN Impact adapter  
PL Redukcja udarowa  
DE Reduktion  
RU Переходник  
CZ Redukce  
HU Redukció  
RO Reducție  
FR Réduction  
IT Prolunga per percussione  
ES Reducción  
CN 风动转换头

1/2" 12.7mm CrMo SCM440

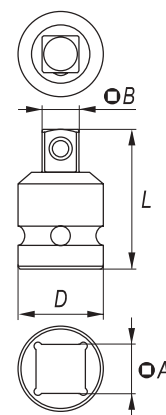

YATO	∅	∅	D [mm]	L [mm]	PCS PCB	
YT-1067	1/2" (12.7 mm) (F)	3/4" (19.0 mm) (M)	30	48	40	160

EN Impact universal joint  
 PL Przegub kulisty udarowy  
 DE Kraft-Kugelgelenk  
 RU Ударный шаровой шарнир  
 CZ Kulový rázový kloub  
 HU Csuklós csatlakozó gépi  
 RO Articulație universală de impact  
 FR Joint universel à impact  
 IT Giunto universale a impatto  
 ES Junta de impacto universal  
 CN 风动万向接头

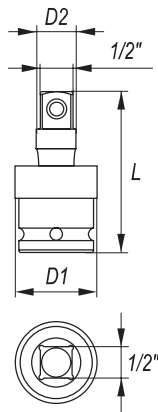

1/2"  
12.7mm  
CrMo  
SCM440

EN Impact universal joint  
 PL Przegub kulisty udarowy  
 DE Kraft-Kugelgelenk  
 RU Ударный шаровой шарнир  
 CZ Kulový rázový kloub  
 HU Csuklós csatlakozó gépi  
 RO Articulație universală de impact  
 FR Joint universel à impact  
 IT Giunto universale a impatto  
 ES Junta de impacto universal  
 CN 重型气动万向接头

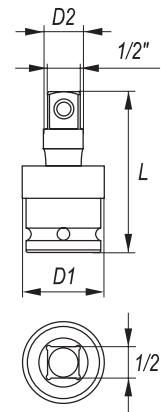

1/2"  
12.7mm  
CrMo  
SCM440

FOR IMPACT TOOLS DO NARZĘDZI UDAROWYCH

YATO	∅	D1 [mm]	D2 [mm]	L [mm]	PCS PER PIECE	
YT-1064	1/2" (12.7 mm)	31	17	63	25	100

YATO	∅	D1 [mm]	D2 [mm]	L [mm]	PCS PER PIECE	
YT-10640	1/2" (12.7 mm)	31.2	16.7	63	10/100	

EN Hexagonal impact socket  
 PL Nasadka udarowa sześciokątna  
 DE Kraftschrauber-Einsatz  
 RU Головка ударная 6-гранная  
 CZ Šestihřanný nástavec  
 HU Gépi dugókulcs hatszög

RO Cheie tubulară hexagonală de impact  
 FR Douille à choc  
 IT Chiave a bussola esagonale per percussione  
 ES Boquilla de percusión  
 CN 风动套筒

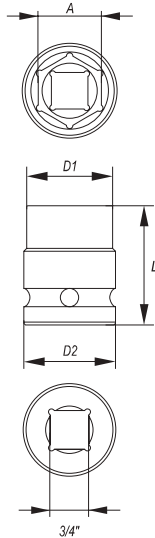

3/4"  
19mm  
CrMo  
SCM440  
AS-DRIVE

EN Hexagonal deep impact socket  
 PL Nasadka udarowa sześciokątna długa  
 DE Kraftschrauber-Einsatz, lang  
 RU Головка ударная 6-гранная глубокая  
 CZ Šestihřanný hluboký nástavec  
 HU Gépi dugókulcs hatszög hosszú

RO Cheie tubulară hexagonală de impact adâncă  
 FR Douille profonde à choc  
 IT Chiave a bussola esagonale per percussione  
 ES Boquilla de percusión profunda  
 CN 风动长套筒

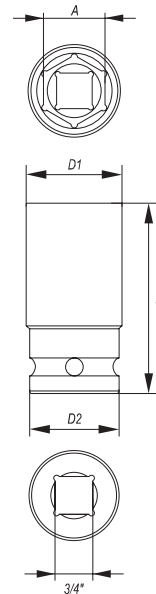

3/4"  
19mm  
CrMo  
SCM440  
AS-DRIVE

YATO	∅ A [mm]	D1 [mm]	D2 [mm]	L [mm]	PCS PER PIECE	
YT-1070	19	32	40	50	16	64
YT-1071	21	35	40	50	16	64
YT-1072	22	38	40	50	16	64
YT-1073	23	38	40	50	16	64
YT-1074	24	40	40	50	16	64
YT-1075	25	40	40	50	16	64
YT-1076	26	40	40	50	16	64
YT-1077	27	42	42	53	16	64
YT-1078	28	44	44	53	16	64
YT-1079	29	46	44	53	12	48
YT-1080	30	46	44	53	12	48
YT-1082	32	48	44	56	12	48
YT-1083	33	48	44	56	8	32
YT-1084	34	50	44	56	8	32
YT-1085	35	50	44	56	6	24
YT-1086	36	52	44	56	6	24
YT-1088	38	56	44	57	6	24
YT-1091	41	60	44	57	5	20
YT-1092	42	61	44	57	4	16
YT-1093	43	63	44	57	4	16
YT-1096	46	66	44	62	3	12
YT-1100	50	71	54	72	3	12
YT-1102	52	74	54	72	2	8
YT-1105	55	78	54	74	2	8
YT-1110	60	84	54	74	2	8

YATO	∅ A [mm]	D1 [mm]	D2 [mm]	L [mm]	PCS PER PIECE	
YT-1119	19	32	44	90	9	36
YT-1121	21	35	44	90	9	36
YT-1122	22	38	44	90	9	36
YT-1124	24	40	44	90	9	36
YT-1127	27	42	44	90	9	36
YT-1128	28	44	44	90	8	32
YT-1129	29	44	44	90	8	32
YT-1130	30	46	44	90	7	28
YT-1132	32	48	44	90	7	28
YT-1133	33	50	44	90	6	24
YT-1134	34	51	44	90	6	24
YT-1135	35	52	44	90	6	24
YT-1136	36	54	44	90	6	24
YT-1138	38	56	44	90	6	24
YT-1141	41	60	44	90	5	20
YT-1142	42	61	44	90	4	16
YT-1143	43	63	44	90	3	12
YT-1146	46	66	44	90	3	12
YT-1148	48	68	44	90	2	8
YT-1150	50	71	54	90	2	8

EN Impact socket set  
PL Zestaw nasadek udarowych  
DE Kraftschrauber-Einsätze  
RU Набор торцевых ударных головок  
CZ Sada úderových nástrojových hlavíc  
HU Gépi dugókulcs készlet

RO Set chei tubulare pt. impact  
FR Jeu de douilles à choc  
IT Set di chiavi a bussola a percussione  
ES Juego de vasos de impacto  
CN 风动套筒组套

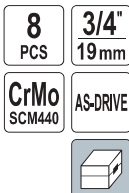

3/4" (19.0 mm): 22, 24 mm (L=50 mm); 27, 30 mm (L=53 mm); 32, 36 mm (L=55 mm); 38, 41 mm (L=57 mm)

<b>YATO</b>	○	6
YT-1115	3/4" (19.0 mm)	

EN Impact extension bar  
PL Przedłużka udarowa  
DE Verlängerung  
RU Удлинитель ударный  
CZ Prodlužovací přípravek  
HU Toldalék

RO Prelungitor  
FR Rallonge  
IT Prolunga per percussione  
ES Tubo de prolongación  
CN 风动接杆



<b>YATO</b>	○	D1 [mm]	D2 [mm]	L [mm]	PCS	ROBIE
YT-1160	3/4" (19.0 mm)	44	24	100	8	32
YT-1161	3/4" (19.0 mm)	44	24	175	10	20
YT-1162	3/4" (19.0 mm)	44	24	250	8	16
YT-1163	3/4" (19.0 mm)	44	24	330	6	12

EN Impact adapter  
PL Redukcja udarowa  
DE Reduktion  
RU Переходник  
CZ Redukce  
HU Redukció  
RO Reducție  
FR Réduction  
IT Prolunga per percussione  
ES Reducción  
CN 风动转换头

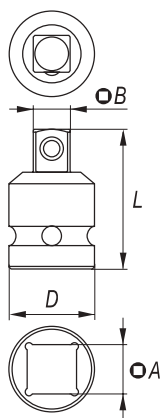

<b>YATO</b>	○	○	D [mm]	L [mm]	PCS	ROBIE
YT-1168	3/4" (19.0 mm) (F)	1" (25.4 mm) (M)	44	63	12	48

EN Impact universal joint  
PL Przegub kulisty udarowy  
DE Kraft-Kugelgelenk  
RU Ударный шаровой шарнир  
CZ Kulový rázový kloub  
HU Csuklós csatlakozó gépi  
RO Articulație universală de impact  
FR Joint universel à impact  
IT Giunto universale a impatto  
ES Junta de impacto universal  
CN 重型气动万向接头

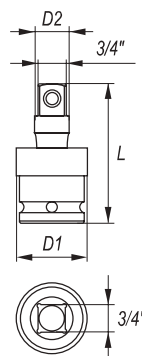

EN Impact socket set  
PL Zestaw nasadek udarowych  
DE Kraftschrauber-Einsätze  
RU Набор торцевых ударных головок  
CZ Sada úderových nástrojových hlavíc  
HU Gépi dugókulcs készlet

RO Set chei tubulare pt. impact  
FR Jeu de douilles à choc  
IT Set di chiavi a bussola a percussione  
ES Juego de vasos de impacto  
CN 风动套筒组套

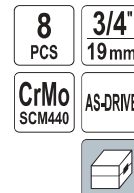

3/4" (19.0 mm): 22, 24, 27, 30, 32, 36, 38, 41 mm (L=90 mm)

<b>YATO</b>	○	4
YT-1155	3/4" (19.0 mm)	

EN Impact adapter  
PL Redukcja udarowa  
DE Reduktion  
RU Переходник  
CZ Redukce  
HU Redukció  
RO Reducție  
FR Réduction  
IT Prolunga per percussione  
ES Reducción  
CN 转接头

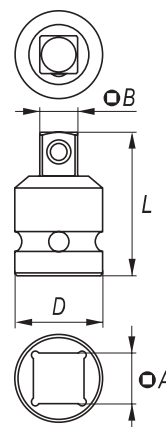

<b>YATO</b>	○	○	D [mm]	L [mm]	PCS	ROBIE
YT-11671	3/4" (19.0 mm) (F)	1/2" (12.7 mm) (M)	44	55	12	48

EN Impact universal joint  
PL Przegub kulisty udarowy  
DE Kraft-Kugelgelenk  
RU Ударный шаровой шарнир  
CZ Kulový rázový kloub  
HU Csuklós csatlakozó gépi

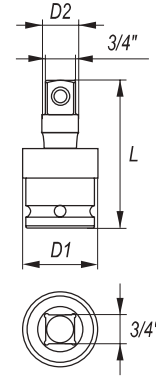

<b>YATO</b>	○	D1 [mm]	D2 [mm]	L [mm]	PCS	ROBIE
YT-1164	3/4" (19.0 mm)	31	44	102	8	32

<b>YATO</b>	○	D1 [mm]	D2 [mm]	L [mm]	PCS	ROBIE
YT-11641	3/4" (19.0 mm)	45.6	25.3	93.3	5/20	

3

EN Hexagonal impact socket  
 PL Nasadka uderowa sześciokątna  
 DE Kraftschrauber-Einsatz  
 RU Головка ударная 6-гранная  
 CZ Šestihranný nástavec  
 HU Gépi dugókulcs hatszög

RO Cheie tubulară hexagonală de impact  
 FR Douille à choc  
 IT Chiave a bussola esagonale per percussione  
 ES Boquilla de percusión  
 CN 风动套筒

**1"**  
**25mm**  
**CrMo**  
**SCM440**  
**AS-DRIVE**

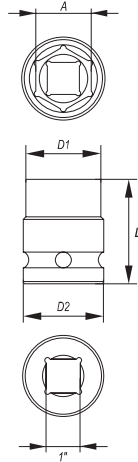

YATO	∅ A [mm]	D1 [mm]	D2 [mm]	L [mm]	PCS PCB	
YT-1180	24	42	54	59	6	24
YT-1183	27	46	54	59	6	24
YT-1184	28	47	54	59	6	24
YT-1185	29	48	54	60	6	24
YT-1186	30	49	54	60	6	24
YT-1187	32	52	54	61	6	24
YT-1188	33	53	54	61	6	24
YT-1189	34	54	54	61	6	24
YT-1191	36	57	54	65	6	24
YT-1193	38	60	54	65	5	20
YT-1194	41	63	54	65	4	16
YT-1196	46	69	54	73	3	12
YT-1197	48	72	54	73	2	8
YT-1198	50	75	54	73	2	8

EN Hexagonal deep impact socket  
 PL Nasadka uderowa sześciokątna długa  
 DE Kraftschrauber-Einsatz, lang  
 RU Головка ударная 6-гранная глубокая  
 CZ Šestihranný hluboký nástavec  
 HU Gépi dugókulcs hatszög hosszú

RO Cheie tubulară hexagonală de impact adâncă  
 FR Douille profonde à choc  
 IT Chiave a bussola esagonale per percussione  
 ES Boquilla de percusión profunda  
 CN 风动长套筒

**1"**  
**25mm**  
**CrMo**  
**SCM440**  
**AS-DRIVE**

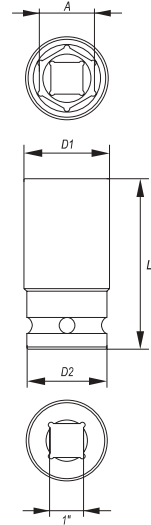

YATO	∅ A [mm]	D1 [mm]	D2 [mm]	L [mm]	PCS PCB	
YT-1175	27	46	54	90	6	24
YT-1176	30	50	54	90	6	24
YT-1177	32	52	54	90	6	24
YT-1178	33	54	54	90	6	24
YT-1179	36	57	54	90	6	24

EN Impact extension bar with adapter  
 PL Przedłużka uderowa z redukcją  
 DE Verlängerung mit Adapter  
 RU Удлинитель с redukcijей  
 CZ Proloužení s redukcí  
 HU Hosszabbító szár adapterrel

RO Bara extensie cu adaptor  
 FR Rallonge avec réduction  
 IT Prolunga per percussione con riduttore  
 ES Tubo de prolongación con reductor  
 CN 风动转换接头



**1"**  
**25mm**  
**CrMo**  
**SCM440**

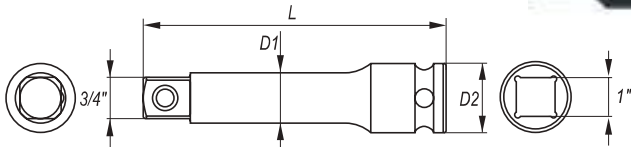

YATO	∅ A	∅ B	D1 [mm]	D2 [mm]	L [mm]	PCS PCB	
YT-1169	1" (25.4 mm) (F)	3/4" (19.0 mm) (M)	53	33	250	6	12

EN Impact universal joint  
 PL Przegub kulisty uderowy  
 DE Kraft-Kugelgelenk  
 RU Ударный шаровой шарнир  
 CZ Kulový rázový kloub  
 HU Csuklós csatlakozó gépi  
 RO Articulație universală de impact  
 FR Joint universel à impact  
 IT Giunto universale a impatto  
 ES Junta de impacto universal  
 CN 重型气动方向接头

**1"**  
**25mm**  
**CrMo**  
**SCM440**  
**FOR IMPACT TOOLS DO NARZĘDZI UDAROWYCH**

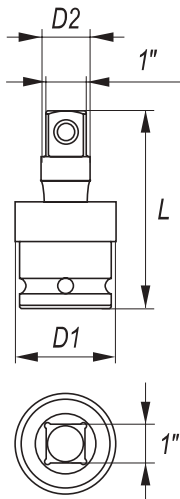

YATO	∅	D1 [mm]	D2 [mm]	L [mm]	
YT-11999	1" (25.4 mm)	54.3	33.9	110	3/12

EN Adaptor set  
 PL Zestaw redukcji  
 DE Reduktionsset  
 RU Редукционный комплект  
 CZ Redukční sada  
 HU Adapter készlet

RO Set adaptoare  
 FR Ensemble de réducteurs pour douilles  
 IT Kit di riduzioni  
 ES Set de reductores  
 CN 气动转换接头组套

**6**  
**PCS**  
**CrV**





3/8" (9.5 mm) (M) x 1/4" (6.3 mm) (F), 1/4" (6.3 mm) (M) x 3/8" (9.5 mm) (F), 3/8" (9.5 mm) (F) x 1/2" (12.7 mm) (M), 1/2" (12.7 mm) (F) x 3/8" (9.5 mm) (M), 3/4" (19.0 mm) (M) x 1/2" (12.7 mm) (F), 1/2" (12.7 mm) (M) x 3/4" (19.0 mm) (F)

YATO	
YT-10671	20

EN Impact universal joint set  
PL Zestaw przegubów udarowych  
DE Kugelgelenk-Satz  
RU Набор ударных шаровых шарниров  
CZ Sada kulových rázových kloubů  
HU Gépi csuklós csatlakozó készlet  
RO Set articulatii universale de impact  
FR Jeu de joints à impact  
IT Kit di giunti universali a impatto  
ES Conjunto de juntas de impacto  
CN 重型气动万向接头组套

**3** PCS  
**1/2"** 12.7mm  
**3/8"** 9.5mm  
**1/4"** 6.3mm  
CrMo 





<b>YATO</b> 		
YT-10643	1/4" (6.3 mm), 3/8" (9.5 mm), 1/2" (12.7 mm)	10/60

EN Impact universal joint set  
PL Zestaw przegubów udarowych  
DE Kugelgelenk-Satz  
RU Набор ударных шаровых шарниров  
CZ Sada kulových rázových kloubů  
HU Gépi csuklós csatlakozó készlet  
RO Set articulatii universale de impact  
FR Jeu de joints à impact  
IT Kit di giunti universali a impatto  
ES Conjunto de juntas de impacto  
CN 重型气动万向接头组套



**3** PCS  
**1/2"** 12.7mm  
**3/8"** 9.5mm  
**1/4"** 6.3mm  
CrMo SCM440  
FOR IMPACT TOOLS DO NARZEDZI UDAROWYCH 



<b>YATO</b> 		
YT-10642	1/4" (6.3 mm), 3/8" (9.5 mm), 1/2" (12.7 mm)	5/20

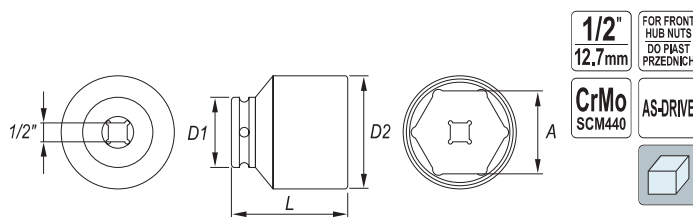

EN Hexagonal impact socket  
PL Nasadka udarowa sześciokątna  
DE Kraftschrauber-Einsatz  
RU Головка ударная 6-гранная  
CZ Šestihranný nástavec  
HU Gépi dugókulcs hatszög  
RO Cheie tubulară hexagonală de impact  
FR Douille à choc  
IT Chiave a bussola esagonale per percussione  
ES Boquilla de percusión  
CN 风动套筒



<b>YATO</b> 		
YT-1029	52 44 71 72	3 12

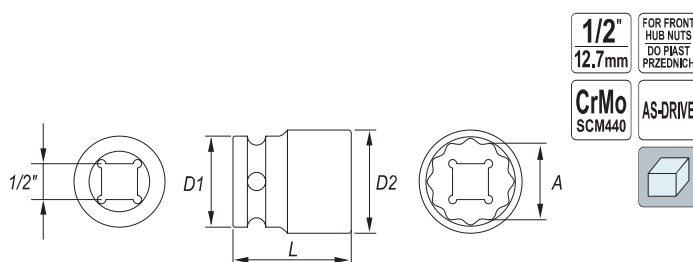

EN Bi-hexagonal impact socket  
PL Nasadka udarowa dwunastokątna  
DE Zwölfkant-Kraftschrauber-Einsatz  
RU Головка ударная 12-гранная  
CZ Vanáctíhranný nástavec  
HU Gépi dugókulcs 12-szögű  
RO Cheie tubulară bihexagonală de impact  
FR Douille à choc  
IT Chiave a bussola esagonale per percussione  
ES Boquilla bihexagonal de percusión  
CN 风动套筒

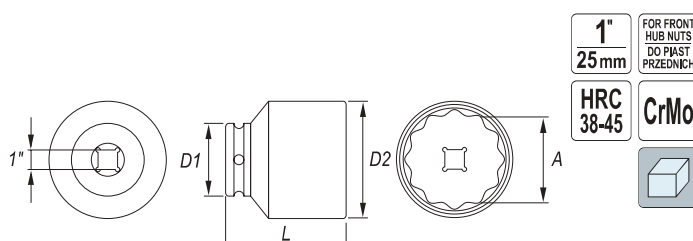

<b>YATO</b> 		
YT-1027	24 30 34 39	10 120

EN Bi-hexagonal impact socket  
PL Nasadka udarowa dwunastokątna  
DE Zwölfkant-Kraftschrauber-Einsatz  
RU Головка ударная 12-гранная  
CZ Vanáctíhranný nástavec  
HU Gépi dugókulcs 12-szögű  
RO Cheie tubulară bihexagonală de impact  
FR Douille à choc  
IT Chiave a bussola esagonale per percussione  
ES Boquilla bihexagonal de percusión  
CN 风动套筒





<b>YATO</b> 		
YT-11990	65 54 93 93	4
YT-11995	80 86 112 100	4
YT-11998	85 86 118 102	4

EN Impact bit socket set  
PL Zestaw udarowych kluczy trzpieniowych  
DE Schlagsteckschlüsselsatz  
RU Набор ударных торцовых ключей  
CZ Souprava rázových zástrčných klíčů  
HU Üthető bit dugókulcs készlet  
RO Set chei de șoc cu bolt  
FR Jeu de douilles à impact  
IT Set di chiavi a bussola per percussione  
ES Juego de llaves de mandril de impacto  
CN 气动一体批组套



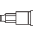

**6** PCS  
  
**1/2"** 12.7mm  
CrMo 



<b>YATO</b> 		
YT-10652	1/2" (12.7 mm)	20

EN Impact bit socket set  
PL Zestaw udarowych kluczy trzpieniowych  
DE Schlagsteckschlüsselsatz  
RU Набор ударных торцовых ключей  
CZ Souprava rázových zástrčných klíčů  
HU Üthető bit dugókulcs készlet

RO Set chei de șoc cu bolt  
FR Jeu de douilles à impact  
IT Set di chiavi a bussola per percussione  
ES Juego de llaves de mandril de impacto  
CN 气动一体批组套

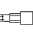

**9** PCS  
  
**1/2"** 12.7mm  
CrMo 

<b>YATO</b> 		
YT-10654	1/2" (12.7 mm)	10

3

EN Impact bit socket set  
 PL Zestaw uderowych kluczy trzpieniowych  
 DE Schlagsteckschlüsselsatz  
 RU Набор ударных торцовых ключей  
 CZ Souprava rázových zástrčných klíčů  
 HU Üthető bit dugókulcs készlet

RO Set chei de șoc cu bolt  
 FR Jeu de douilles à impact  
 IT Set di chiavi a bussola per percussione  
 ES Juego de llaves de mandril de impacto  
 CN 气动一体批组套

**9**  
PCS





**1/2"**  
12.7mm

**CrMo**



 1/2" (12.7 mm): RM5, RM6, RM7, RM8, RM9, RM10, RM12, RM13, RM14

<b>YATO</b> 		
<b>YT-10681</b>	1/2" (12.7 mm)	10

EN Impact bit socket set  
 PL Zestaw uderowych kluczy trzpieniowych  
 DE Schlagsteckschlüsselsatz  
 RU Набор ударных торцовых ключей  
 CZ Souprava rázových zástrčných klíčů  
 HU Üthető bit dugókulcs készlet

RO Set chei de șoc cu bolt  
 FR Jeu de douilles à impact  
 IT Set di chiavi a bussola per percussione  
 ES Juego de llaves de mandril de impacto  
 CN 气动一体批组套

**9**  
PCS





**1/2"**  
12.7mm

**CrMo**



 1/2" (12.7 mm): M4, M5, M6, M8, M9, M10, M12, M14, M16

<b>YATO</b> 		
<b>YT-10691</b>	1/2" (12.7 mm)	10

EN Impact bit socket set  
 PL Zestaw uderowych kluczy trzpieniowych  
 DE Schlagsteckschlüsselsatz  
 RU Набор ударных торцовых ключей  
 CZ Souprava rázových zástrčných klíčů  
 HU Üthető dugókulcs bit - készlet  
 RO Set chei de șoc cu bolt  
 FR Set de douilles à choc  
 IT Set di chiavi a bussola per percussione  
 ES Juego de llaves de vaso de impacto  
 CN 风动套筒批头组套



**8**  
PCS



**1/2"**  
12.7mm

**HRC 54**

**CrMo**







  1/2" (12.7 mm): T30, T40, T45, T50, T55, T60, T70, T80



<b>YATO</b> 		
<b>YT-1065</b>	1/2" (12.7 mm)	15



  1/2" (12.7 mm): 6, 7, 8, 10, 12, 14, 17, 19 mm



<b>YATO</b> 		
<b>YT-1066</b>	1/2" (12.7 mm)	15





  1/2" (12.7 mm): RM5, RM6, RM7, RM8, RM10, RM11, RM12, RM13

<b>YATO</b> 		
<b>YT-1068</b>	1/2" (12.7 mm)	15



  1/2" (12.7 mm): M5, M6, M8, M10, M12, M14, M16, M18

<b>YATO</b> 		
<b>YT-1069</b>	1/2" (12.7 mm)	15

EN Impact bit with holder set  
 PL Zestaw uderowych kluczy trzpieniowych z nasadką  
 DE Schlagschrauber-Steckschlüsselsatz mit Schutzkappe  
 RU Набор ударных ключей с торцевыми головками  
 CZ Sada imbusových nástrčných klíčů  
 HU Gépi hatlapú dugókulcs készlet  
 RO Set biti si adaptor impact  
 FR Jeu de clés à choc avec douille  
 IT Set di chiavi a brugola con punta  
 ES Juego de llaves de vaso de impacto  
 CN M型冲击批头组套



**9**  
PCS



**1/2"**  
12.7mm

**CrMo**

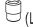

**S2**





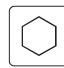

  1/2" (12.7 mm): T30, T40, T45, T47, T50, T55, T60, T70;  
 (L=35 mm)



<b>YATO</b> 		
<b>YT-10664</b>	1/2" (12.7 mm)	6/36



  1/2" (12.7 mm): 6, 7, 8, 10, 12, 14, 17, 19 mm;  
 (L=35 mm)

<b>YATO</b> 		
<b>YT-10662</b>	1/2" (12.7 mm)	6/36

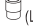

  1/2" (12.7 mm): M6, M8, M9, M10, M12, M14, M16, M18;  
 (L=35 mm)

<b>YATO</b> 		
<b>YT-10663</b>	1/2" (12.7 mm)	6/36

- EN Spline impact bit set
- PL Zestaw bitów udarowych Spline
- DE Schlagwerkzeugsatz Spline
- RU Набор ударных битов Spline
- CZ Souprava bitů pro rázové utahováky Spline
- HU Utó bit készlet Spline
- RO Set tubulare de impact
- FR Set d'embouts à choc
- IT Set di chiavi a bussola per percussione Spline
- ES Juego de las piezas de percusión Spline
- CN 风动花键批头组套



6 PCS	XZN
3/4" 19 mm	CrMo

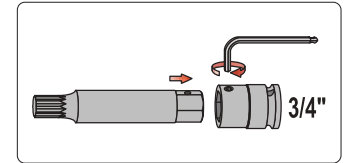

M12, M14, M16, M18 x 22 mm; (L=107 mm); CrMo;

3/4" (19 mm) x 22 mm; CrMo;

<b>YATO</b>		
YT-1157	3/4" (19.0 mm)	8

- EN Impact bit socket set
- PL Zestaw udarowych kluczy trzpieniowych
- DE Schlagsteckschlüsselsatz
- RU Набор ударных торцовых ключей
- CZ Souprava rázových zástrčných klíčů
- HU Üthető bit dugókulcs készlet
- RO Set chei de șoc cu bolt
- FR Jeu de douilles à impact
- IT Set di chiavi a bussola per percussione
- ES Juego de llaves de mandril de impacto
- CN 气动一体批组套



6 PCS	
3/4" 19 mm	CrMo

3/4" (19.0 mm); M16, M18;

3/4" (19.0 mm); T70, T80, T90, T100

<b>YATO</b>		
YT-10653	3/4" (19.0 mm)	10

- EN Impact bit socket set
- PL Zestaw udarowych kluczy trzpieniowych
- DE Schlagsteckschlüsselsatz
- RU Набор ударных торцовых ключей
- CZ Souprava rázových zástrčných klíčů
- HU Üthető bit dugókulcs készlet
- RO Set chei de șoc cu bolt
- FR Jeu de douilles à impact
- IT Set di chiavi a bussola per percussione
- ES Juego de llaves de mandril de impacto
- CN 气动套筒组套



12 PCS	1/2" 12.7 mm
3/4" 19 mm	CrMo
FOR TRUCKS DO AUT CIEZAROWYCH	

3/4" (19 mm) (F); CrMo;

1/2" (12.7 mm) (M); CrMo;

3/4" (19 mm) (M) (L=200 mm); CrMo;

T70, T80, T90, T100 (L=67 mm); CrMo;

14, 17, 19, 21, 22 mm (L=67 mm); CrMo;

3 mm

<b>YATO</b>		
YT-10655	1/2" (12.7 mm), 3/4" (19.0 mm)	5